

**OPERATING INSTRUCTIONS
WARRANTY & SERVICE GUIDE**

MOVADO FACE WATCHES

In a world that gives you more—more information, more options, more upgrades, more accessories – Movado Face is featuring less. No doodads. No definitions. Just curated, pared-down, perfected design—born from Bauhaus, and made modern for whatever era you’re in. Exactly what’s needed and nothing more.

CONTENTS

OPERATING INSTRUCTIONS

- STANDARD 2-HAND MODELS

SPECIAL FEATURES

- INTERCHANGEABLE BRACELET/STRAP
- MESH BRACELET SIZING

CARE AND MAINTENANCE

WARRANTY INFORMATION

STANDARD 2-HAND OPERATING INSTRUCTIONS

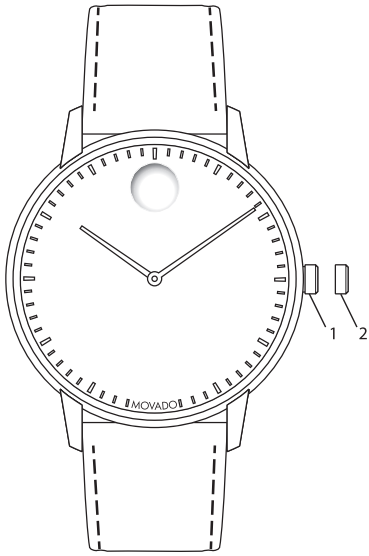

Crown Positions:

Position 1 - Normal position. Crown pushed into case.

Position 2 - To set TIME: Rotate crown in either direction.

INTERCHANGEABLE BRACELET/STRAP

Removing Strap

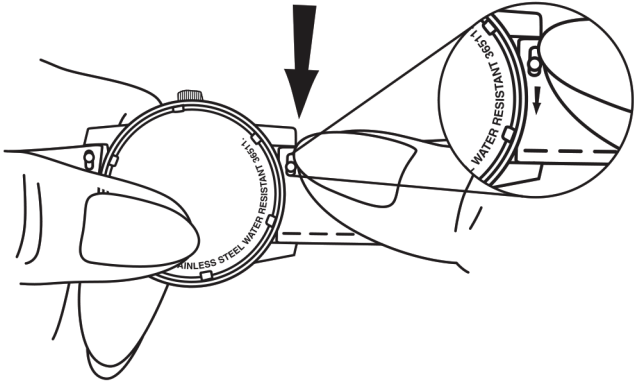

1A

Replacing Strap

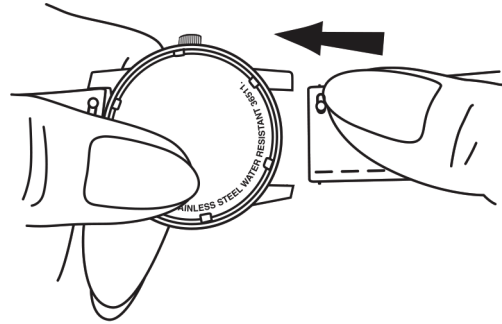

1A

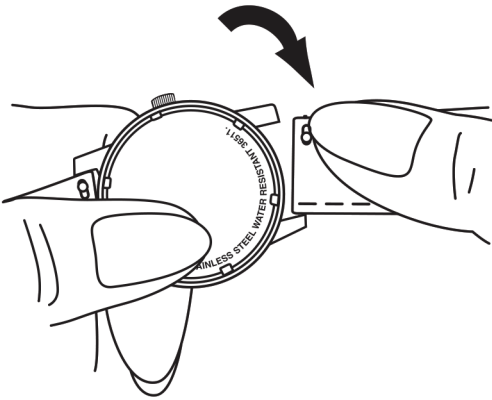

2A

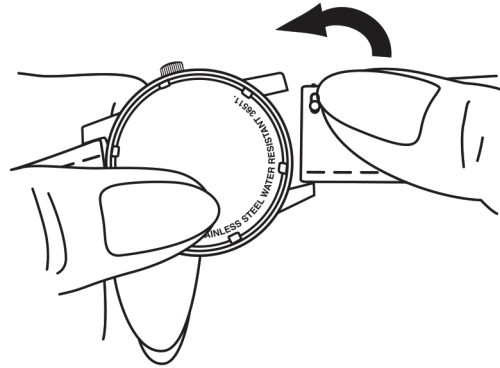

2A

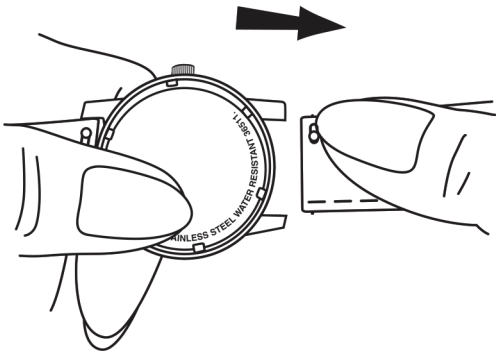

3A

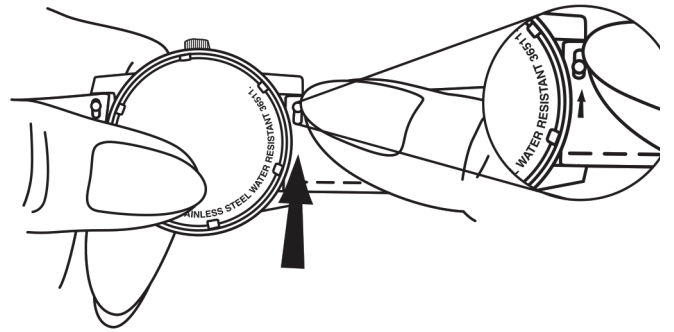

3A

MESH BRACELET SIZING

The mesh bracelets found on select models feature a hooking jewelry clasp that allows you to size the bracelet by sliding the pin-bar half of the clasp along the bracelet to achieve a customized fit.

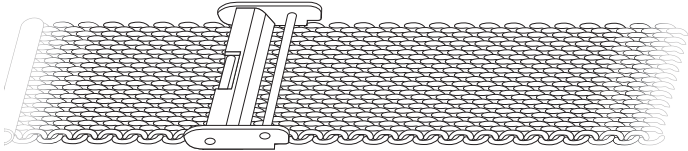

Above: Open mesh bracelet side with pin-bar half of sliding clasp locked in position.

To size the bracelet:

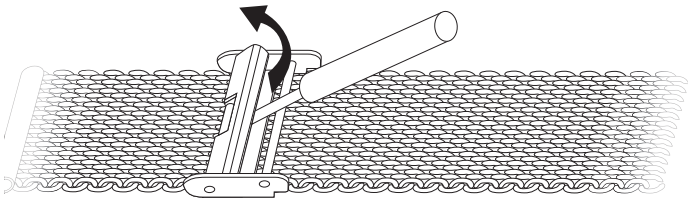

1. Use tool such as a small flat-head screwdriver to pop open metal plate on pin-bar half of clasp, releasing the clasp position locking mechanism.

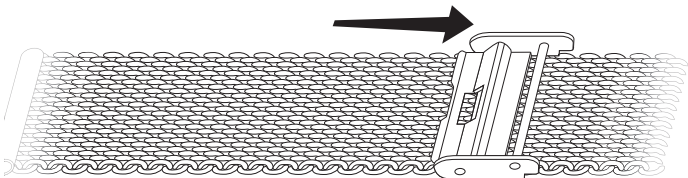

2. Slide pin-bar half of clasp along the mesh bracelet in either direction to desired position.

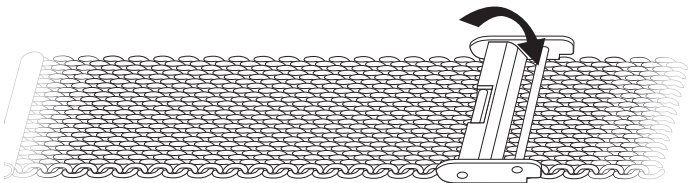

3. Close metal plate, locking the pin-bar half of the clasp in new position on the bracelet.

CARE AND MAINTENANCE

CARE AND MAINTENANCE

Like any finely crafted mechanism, your Movado Face watch requires periodic maintenance to ensure optimal performance. Maintenance includes complete disassembly, cleaning, replacement of parts as needed, reassembly and lubrication of the movement. A maintenance interval of 3 to 5 years is recommended, in addition to any required battery replacement.

Never open the watch yourself. If your watch needs repair or adjustment, take or mail it directly to a Movado Authorized Service Center. For a complete worldwide listing, visit us online at www.movado.com/face.

NOTE: The Movado Watch Company assumes responsibility only for service performed at its Authorized Service Centers.

SHOCK

All Movado watches have shock-resistant movements, individually tested to meet international standards.

DUST

Dust can enter a watch if the case, crystal or crown is not intact. A small particle is enough to stop the movement. Have your watch repaired promptly if the crystal becomes loose, chipped or cracked, or if there is damage to the case or crown.

MAGNETISM

The exposure of a timepiece to strong magnetic fields will affect its time-keeping and may cause it to stop. A quartz watch should resume working with its original accuracy when removed from the magnetic field.

WATER RESISTANCE

All Movado Face watches are tested to meet international standards for water resistance.

All styles are water resistant to 30 meters (3 bar/3ATM/99 feet).

CAUTION: If the water resistance limit is not marked on your watch, do not subject it to a pressure/depth greater than 3 bar (3 ATM/30 meters/99 feet), or your watch could be damaged and your warranty will be voided.

IMPORTANT: Do not operate the watch crown, push-buttons on a chronograph model, or any other pushers/buttons when the timepiece is wet or under water.

NOTE: The Movado Watch Company will not be responsible for any damage caused by or related to leakage originating from improper handling or damage to the case, crown, gaskets or crystal.

To maintain water resistance, yearly maintenance is required. The gaskets and crown which seal the case are subject to wear and deterioration under normal use. These parts should be inspected and replaced as needed each time the watch is opened for service, including battery changes.

Your Authorized Movado Service Center will automatically retest your watch for water resistance as a routine step in all service orders.

OTHER PRECAUTIONS

Water resistance applies only to the watch case; some watch straps should not be worn under water or subjected to wet conditions. Please see STRAP CARE.

Avoid exposing your watch to sudden and excessive temperature variations.

Do not drop your watch or bang it against a hard surface. Water resistance must be rechecked after every violent shock.

Clean your watch regularly by wiping it with a soft cloth dampened with fresh water, especially after exposure to seawater.

CARE AND MAINTENANCE

STRAP CARE

While the life span of a watch strap depends on your care and wearing habits, as well as the climate in which you live, proper care will extend its life.

Leather straps should be kept dry. Exposure to water may cause a leather watch strap to become brittle and eventually break. To preserve the finish of the leather, contact with perfumes should be avoided. Following exposure to chlorinated or salt water, gently wipe your leather strap with fresh water, and air dry.

NOTE: Movado watch straps are not covered by the Movado watch warranty.

BATTERY INFORMATION

A Movado quartz timepiece has a 1.55 Volt silver-oxide battery that is specially designed for watches. It will last approximately 18 – 36 months under normal use.

NOTE: Frequent use of special functions, like the stopwatch timer on chronograph models, may shorten battery life.

End-of-life feature: The seconds hand on many models will start to move haltingly in 4-second increments when the battery is almost exhausted, signaling the need to have it replaced.

Battery replacement: It is important to use only the replacement battery recommended by Movado. Take or send your watch to an Authorized Service Center to have battery changed – your old battery will be disposed of/recycled properly. Do not attempt to change the battery yourself.

WARRANTY INFORMATION

Not only is each Movado watch beautiful in design, but it is also crafted with quality materials and components to offer precise, reliable performance. We proudly stand behind every Movado watch we sell.

MOVADO LIMITED WARRANTY

Movado warrants to the original consumer that, for a period of two (2) years from the date of purchase, his/her watch will be free from defects in materials and workmanship that prevent the watch from functioning properly under normal use.

Our responsibility for defects covered by this warranty is limited to repairing or (at the sole discretion of Movado) replacing the defective watch, free of charge.

This limited warranty does not cover analog batteries, straps, bracelets, crystals, gold- or ionic-plating or PVD finishing, cosmetic issues such as scratches or normal wear and tear, or any damage arising from accidents or misuse, or from any alteration, service or repair performed by any party other than a Movado Authorized Service Center.

Please keep your dated sales or gift receipt showing an identifying watch style number as proof of purchase for service under warranty.